

KERSTAR

Part of Absolent Air Care Group

KAV 18, KAV 20, KAV 30 & KAV 45

Wet or Dry Pick-Up Compressed Air Powered Vacuum Cleaner

Category 2 (Dust Zone 21 / Gas Zone 1)

UK
CA



II 2 D Ex h IIIC T50°C DbII 2 G
Ex h IICT6 Gb

Operating Instructions



Please read carefully before use



Contents

IMPORTANT USER INFORMATION	3
UNPACKING YOUR KAV VACUUM CLEANER	5
COMMISSIONING YOUR KAV VACUUM CLEANER	5
PERFORMANCE/COMPRESSED AIR REQUIREMENTS	6
RISK ASSESSMENT (ATEX/UKEX)	7
OPERATING INSTRUCTIONS	7
CARRYING & STORAGE	7
OPTIONAL EXTRAS	7
ACCESS TO THE FLOAT/FILTRATION SYSTEM	8
TO SET UP FOR WET PICK UP	8
EMPTYING LIQUID FROM CANISTER	8
TO SET UP FOR DRY PICK UP	8
CLEANING THE FILTERS	9
FILTRATION SYSTEM	9
LOSS OF SUCTION	9
KAVITATION INTERCEPTOR TANK	10
SERVICING & SPARES	10
GUARANTEE	11
RATING PLATE	11
SPARE PARTS – KAV 18 W/D	10
EU DECLARATION OF CONFORMITY (DoC)	13
UKCA DECLARATION OF CONFORMITY	14
(DoC)	14
TOOL KIT KAV 18, 20, 30 & 45 W/D	15

IMPORTANT USER INFORMATION

This instruction book should be retained with this appliance for future reference. Should this appliance be sold or transferred to another user, always ensure that this book is supplied with the appliance so the user has the relevant information required to safely use and maintain the KAV cleaner. The warnings in this manual are provided in the interest of safety. You must read them carefully before installing or using this appliance.

It is dangerous to alter the specification or modify this appliance in any way. This appliance is a Wet or Dry Pick- Up Compressed Air Vacuum Cleaner and is designed for use in five different environments:

- 1) To pick up non-explosive dust and debris in an unzoned atmosphere.
- 2) To pick up non-explosive dust and debris in a Gas Zone 1 atmosphere (a Gas Zone 1 atmosphere is where flammable gases, vapours and mists are likely to occur).
- 3) To pick up dust and debris that may explode if ignited (Dust Zone 21) in an area where no flammable gases, vapours or mists are present. (A Dust Zone 21 atmosphere is where a potentially explosive dust cloud is likely to occur).
- 4) To pick up dust and debris that may explode if ignited (Dust Zone 21) in a Gas Zone 1 atmosphere.
- 5) To pick up Non Flammable and Non Corrosive Liquids where a Gas Zone 1 and/or Dust Zone 21 atmosphere may or may not be present.

Before using this appliance or any of the optional extras a risk assessment must be carried out by a competent person to ensure that this appliance is suitable for the application. The risk assessment is the responsibility of the customer/end user. The manufacturer and/or his agent are not qualified to make the risk assessment on behalf of the end user.

SPECIFIC CONDITIONS OF USE:

- 1) This appliance is not suitable for picking up hazardous dusts that may endanger health. These are defined as non-radioactive and non-explosive dusts that are hazardous to health if inhaled, ingested or in contact with the skin. A hazardous dust can be defined as very toxic, harmful, corrosive or irritant. Some dusts may be subject to an exposure limit in the country of use. Micro-organisms may be considered as dusts creating a hazard to the health of a person.
- 2) This appliance is not suitable for collecting radioactive dust.
- 3) This vacuum cleaner is not suitable for picking up dust with an ignition energy of less than 1mJ.
- 4) This appliance is not suitable for picking up flammable or corrosive liquids.
- 5) This appliance is designed for indoor use and should be used with care outdoors. It should not be stored outdoors.
- 6) The air supply hose has a special conductive lining to dissipate any static build up down to earth. The end piece you fit must be metal and your air supply pipe system must be earthed.
- 7) The air supply hose should be kept away from heat, oil, sharp edges and rough surfaces. If there is a risk of the air supply hose being severed an air fuse should be fitted. A suitable air fuse is available from Kerstar.
- 8) If your air supply hose is damaged and needs replacing it MUST be replaced by a

conductive supply hose available from Kerstar. Do not use any other air supply hose.

- 9) It is strongly advised that the earth path continuity between the pick-up tool and the earthed air supply system is checked by a competent person at regular intervals and documentary records kept of these checks.
- 10) Air compressors used to supply this vacuum cleaner must incorporate a filter on the intake system to avoid ingress of dust or foreign material into the parts where compression takes place and must employ only lubricants which are resistant to ignition or carbonisation within the equipment's operating temperature range.
- 11) This appliance should not be used with pyrophoric or self-reactive dusts.
- 12) This vacuum cleaner must not be used to pick up glowing dust/particles or other ignition hazards.
- 13) When picking up swarf and similar metallic parts, the KAV must not be used to pick up potentially explosive dusts or be used in potentially explosive atmospheres. Note: when rusty steel and aluminium items collide with sufficient energy it is possible to generate a spark.
- 14) Use only the hose and accessories supplied with this vacuum cleaner. These have been ATEX/UKEX tested and assessed as suitable for use with this appliance. A wider range of ATEX/UKEX approved accessories is available from Kerstar. NEVER use any other hose or accessories.
- 15) When collecting dust or debris that may ignite or explode empty the cleaner after every use.
- 16) Use only Kerstar approved accessories and spare parts.
- 17) Appropriate Personal Protective Equipment in the form of ear defenders should be worn while using the machine.
- 18) The magnitude of vibration emissions for the machine at the hose end is below 2.5m/s^2 . Only use the caddy handle or the vacuum cleaner main handle for moving the device to the desired location.
- 19) This appliance must be disconnected from the air supply before any maintenance tasks are carried out. Always remove liquids from the container after use.
- 20) This appliance is not intended for use by children, and where children are present, they must be supervised at all times, to prevent them from playing or using the machine in any way. This appliance is not intended for use by persons with reduced physical, sensory or mental capabilities, or lack of experience and knowledge.
- 21) Do not use the appliance for dry vacuuming with the filters and/or Microfibre bag removed.
- 22) Under no circumstances should you attempt to repair the appliance yourself. Repairs undertaken by unauthorised or inexperienced persons may cause injury and/or serious malfunctioning.
- 23) This appliance must only be serviced by authorised Kerstar personnel and only genuine Kerstar spare parts should be used.



UNPACKING YOUR KAV VACUUM CLEANER

Unpack the carton and ensure that you have a complete set of accessories as listed below:

- 1 KAV Compressed Air Powered Vacuum Cleaner
- 1 Yellow A/S Air Supply Hose
- 1 38mm x 3m A/S Hose Assembly
- 1 38mm Stainless Steel Bent Hose End
- 2 38mm Stainless Steel Wands
- 1 38 x 375mm A/S Heavy Duty Floor Tool with Brushes
- 1 38 x 375mm A/S Heavy Duty Floor Tool with Blades
- 1 38mm Crevice Tool A/S Plastic
- 1 38 x 70mm A/S Dusting Brush
- 1 38 x 100mm A/S Dusting Brush
- 1 A/S Dry Filter Assembly
- 5 K4 Microfibre Bags
- 1 Yellow Earth Path Continuity Certificate

Optional extras:

Hose & Accessory Basket (KAV 18, 30 & 45

W/D only) Dump Valve (KAV 18, 30 & 45 W/D)

32 x 800mm Drain Hose and Stopper (KAV 18, 30 & 45

W/D) KAVIT W Interceptor Tank for wet pick up

Models on a caddy (KAV 18, 30 & 45) are packed with the caddy handle removed for transport/packing purposes. Refit handle before use.

COMMISSIONING YOUR KAV VACUUM CLEANER

Attach the anti-static air supply hose to the air inlet port on the control valve. Do not over-tighten the connection. Do not use any form of liquid thread locker or PTFE tape to seal the thread. The threaded end fitting has its own integral O ring seal. If you use liquid thread sealer or PTFE tape you may create an insulated barrier so that any static build up cannot dissipate to earth down the air supply hose.

Fit a metal (conductive) fitting to suit your air outlet sockets to the other end of the air supply hose. Make sure the pipework and outlet fittings of your air supply system is constructed entirely of metal pipes and fittings, and is suitably earthed. Finally using a 500 volt megohmmeter measure the resistance between the body of the vacuum cleaner and the metal air supply pipe. The reading must be no more than 50 Megohm (5×10^7 Ohm).

PERFORMANCE/COMPRESSED AIR REQUIREMENTS

The KAV range does not require the air supply to be dried or filtered. It is advisable to use an air supply that can be regulated so that the performance of the unit can be adjusted to suit the operator. The performance is related to the air input. The more pressure/volume of air input, the more suction/induced airflow is generated. However, using excessive air input wastes compressed air, generates unnecessary noise, and may cause implosion of the canister and/or bursting of the Microfibre bags/filters.

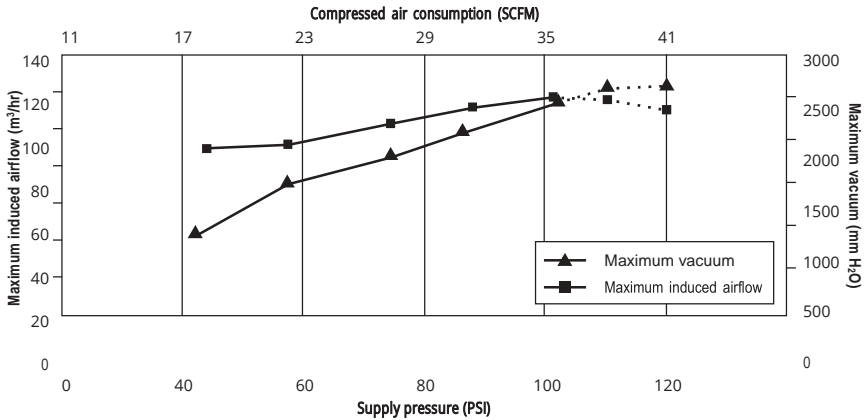

Note: Optimum performance is achieved at an air input pressure of 90-120psi (6.2-8.3 Bar).

RISK ASSESSMENT (ATEX/UKEX)

If this vacuum cleaner is used for collecting flammable/explosive materials, or within a zoned area classified under the 'ATEX Directive 2014/34/EU' / 'Equipment and Protective Systems Intended for use in Potentially explosive Atmospheres Regulations 2016', then a risk assessment must be carried out by a competent person to verify the suitability of the application.

The risk assessment is the responsibility of the customer/end user and should take into account, but not be limited to, the characteristics of the material being collected such as:

1. Spark ignition sensitivity
2. Hot surface ignition sensitivity (cloud)
3. Hot surface ignition sensitivity (layer)
4. Explosion severity
5. Burning behaviour
6. Thermal instability
7. Chemical instability
8. Static electricity generation
9. Impact of collected material
10. The ATEX/UKEX certification code for the appliance being assessed. (See the rating plate on the machine).

OPERATING INSTRUCTIONS

Connect the KAV to a suitable compressed air supply. Attach the anti-static hose assembly to the canister and connect the stainless steel bent hose end and wands. Choose and attach one of the anti-static tools supplied. To activate the KAV turn the lever on the control valve through 90°. The performance of the vacuum cleaner can be controlled with the control valve but it is advisable to fit a regulator and pressure gauge at the air outlet point of your compressed air supply. The maximum pressure must be no more than 120psi (8.3 Bar).

CARRYING & STORAGE

The assembled cleaner can be moved around by pulling the vacuum hose, using the flip/flop handle on the motor head, or by means of the tubular handle (*models on caddy only*). **It must NOT be dragged around by means of the air supply hose.**

When not in use, this vacuum cleaner should be disconnected from the compressed air supply. This vacuum cleaner should be stored indoors in a dry environment.

OPTIONAL EXTRAS

Hose & Accessory Basket – zinc plated tool basket to prevent a build-up of static. It can be fitted by hanging from the two horizontal crossbars on the rear of the caddy. Suitable for models KAV 18, 30 & 45 W/D only.

Dump Valve or Drain Hose and Stopper – to allow the emptying of liquid from the canister without removing the air motor head and float assembly. Suitable for models KAV 18, 30 & 45 W/D only.

Warning – the dump valve or drain hose and stopper is only suitable for emptying liquids from the canister. If the dump valve or drain hose requires cleaning, a damp or wet cloth should be used. DO NOT use a dry cloth.

ACCESS TO THE FLOAT/FILTRATION SYSTEM

To remove the motor head unclip all clips. Ensure that the clips are hinged clear of the rim of the motor head. Lift the motor head clear of the canister.

To refit the motor cover head align the head so that the control valve lies directly opposite the hose entry on the canister. Locate the clips over the rim of the motor head and firmly press down the clips until they have locked into position.

TO SET UP FOR WET PICK UP

1. Remove motor head
2. Remove dry filter and Microfibre bag
3. Make sure the canister is empty and clean
4. Place the float assembly in the canister
5. Replace motor head – **the machine is now ready for wet use only**
6. When the machine is full the float will rise automatically and cut off the suction - preventing any more water being picked up. The machine should then be emptied.

WARNING Switch off and disconnect the air supply before cleaning or emptying. During wet use **if foam or liquid comes from the exhaust switch off immediately.**

If liquid comes from the exhaust, foam is being generated in the canister. Disconnect the air supply. Separate the vacuum motor head from the canister and tip the liquid out of the exhaust vent until completely drained. Leave the vacuum motor head in a warm and dry environment to dry out before using again.

EMPTYING LIQUID FROM CANISTER

All models: Remove motor head and float assembly as described above.

Models on chassis (KAV 20 W/D): Gently tip liquid from the canister into a suitable drain, sink or toilet.

Models on caddy (KAV 18, 30 & 45 W/D): As above and if required the canister can be removed from the caddy by unlocking the toggle clip situated at the rear of the canister.

If a dump valve or drain hose are fitted, disconnect the air supply and move the vacuum cleaner near to or over a suitable drain. Open the dump valve or unclip the drain hose and flip the stopper to allow the liquid to escape.

TO SET UP FOR DRY PICK UP

1. Remove motor head
2. Remove float assembly
3. Empty can of any water and dry out with sponge or cloth
4. Fit 1st stage disposable Microfibre bag
5. Fit 2nd stage anti-static cloth filter assembly
6. Refit motor head – **the machine is now ready for dry use only**

Important

When used for dry vacuuming both stages of dry filtration MUST be used.

CLEANING THE FILTERS

1st Stage Microfibre Bag – Microfibre bags cannot be emptied and must be replaced when full, torn or if they have holes in

2nd Stage Anti-static Cloth Filter:

- a) Brush dust off filter, or
- b) Vacuum dust off with another vacuum cleaner.

FILTRATION SYSTEM

This vacuum cleaner is fitted with two stages of filtration. Both stages are on the negative pressure (suction) side of the motor.

1)1st Stage: K4 Microfibre Bag – KAV 18, 20, 30 & 45 W/D 25-712-10-008

The K4 Microfibre disposable bag is made from Microfibre material. Microfibre bags offer better filtration efficiency, greater tear resistance from sharp debris than paper bags and are less likely to burst when full of heavy dust/debris. K4 Microfibre disposable bags are fitted with a moulded plastic flange and sealing cap. They are fitted over the inlet inside the canister and the dust/debris is collected inside the bag. The sealing cap is designed to prevent the escape of dust from the bag during the bag change and disposal process. When the bag is full or suction efficiency is impaired, it should be replaced. Microfibre bags are not designed to be emptied and should not be reused.

2) 2nd Stage: Anti-static Cloth Filter Assembly – KAV 18 W/D Part No. 25-712-20-014
– KAV 20, 30 & 45 W/D Part No. 25-712-20-015

A conductive needlefelt cloth filtration media attached to a conductive rubber sealing ring and supported by a conductive plastic rigid filter frame.

LOSS OF SUCTION

If your cleaner loses suction power first check that the hose and other accessories in use are not blocked. Then check that the filtration system is not blocked. The filtration system can be serviced as follows:

Microfibre bags – If full, replace.

– If burst, empty/clean out canister and replace.

Cloth Filter Assembly – This filter will become contaminated with dust during normal use and/or if the Microfibre bag has holes in or has burst. The dust must be removed either by brushing off or by vacuuming with another vacuum cleaner. It is advisable to have a spare filter so that the machine itself can be used to vacuum the dust off the contaminated filter.

If any of the filters or Microfibre bags are damaged or have holes in they must be replaced with new items.

KAVIT W INTERCEPTOR TANK

The KAVIT W Interceptor Tank is an optional extra accessory designed to intercept non-flammable and non-corrosive liquids before they reach the KAV W/D vacuum cleaner. As standard it is fitted with a 14" A/S float assembly. For dry pick up, the A/S float assembly should be replaced with a 14" A/S sealing ring and frame without cage (optional extra). If required the KAVIT Interceptor can be fitted with a K4 Microfibre bag and 14" A/S filter assembly to prevent the carry over of dry dust or debris to the main vacuum cleaner. The KAVIT Interceptor is not designed to collect health endangering dust and debris.

The KAVIT Interceptor Tank is rated ATEX/UKEX Category 2 and suitable for Dust Zone 21 and Gas Zone 1 only when used with a Category 2 KAV 15 – 45 model.

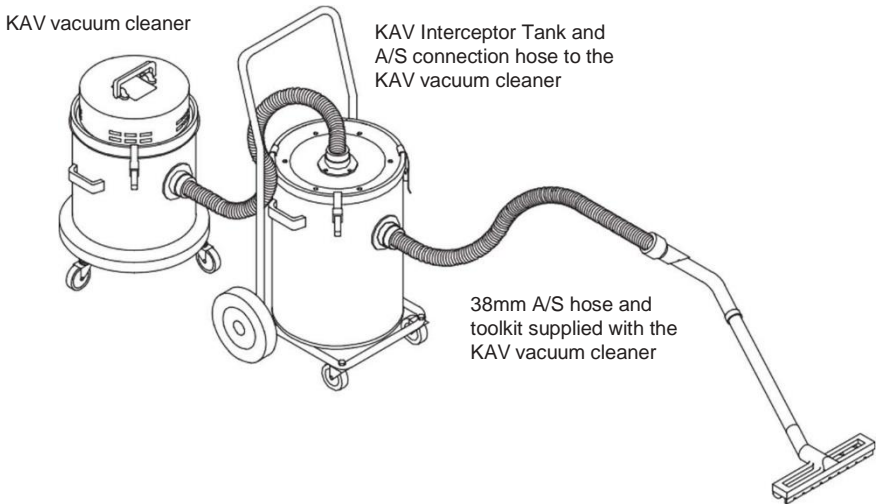

SERVICING & SPARES

Should your Kerstar KAV need any servicing, repair or spares, please contact your nearest Kerstar dealer or contact Kerstar directly:

Tel: +44 (0)1952 290500

Email: sales@filtermist.com

More details on servicing can be found on the Kerstar website www.kerstar.com.

Please make a note of the model and serial number before contacting Kerstar.

GUARANTEE

Kerstar products are guaranteed for 12 months against defective parts and workmanship. Parts that are subject to normal wear and tear are excluded. There are certain conditions that may invalidate this guarantee.

- a) This appliance must be correctly installed and used in accordance with these instructions.
- b) Servicing must be carried out by Kerstar authorised personnel only.
- c) The guarantee may be invalidated by unauthorised repair or modification to the appliance.

Kerstar may introduce modifications to its products from time to time and consequently the details given in this instruction book are subject to alteration without notice.



Please visit www.kerstar.com for full Terms and Conditions and to activate your warranty.

RATING PLATE

The rating plate gives precise information about this product. A full explanation is given below.

1. Name and address of manufacturer
2. Manufacturer's model or type number
3. Year of manufacture, assembly or construction
4. The serial no.

For example, 18A 12345 – made in January
2018 number 12345

5. The  mark
6. The  mark
7.  symbol. The distinctive community mark showing a product is suitable for use in a potentially explosive dust and/or gas atmosphere.
8. **II** – equipment group II (surface industries)
9. **2** – Category 2 product
10. **Exh** – Protection Concept – Constructional Safety (applies to the mechanical parts of the vacuum cleaner)
11. **D** – explosive dust atmosphere
Note: As part of the Ignition Hazard Assessment the inside of the canister has been tested and approved as Category 1 Dust Zone 20.
12. **IIIC T50°C Db** – IIIC dust group – conductive dust

- **T50°C** surface temperature for dust evaluation less than 50°C
- **Db** dust atmosphere EPL (Equipment Protection Level Zone 21)



13. **G** – explosive gas, vapour or mist atmosphere
14. **IICT6 Gb** – **IIC** gas group – suitable for group II gases, vapours and mists (Hydrogen & Acetylene)
 - **T6** surface temperature classification for gases, vapours and mists less than 85°C
 - **Gb** gas atmosphere EPL (Equipment Protection Level Zone 1)
15. **ATEX Certificate No. EMT17ATEX0050X** – The KAV 15-45 range has been tested and approved by an independent test house.
X – refer to instruction book for special operating or user instructions.
16. **UKEX Certificate No. EMA21UKEX0068X** – The KAV 15-45 range has been tested and approved by an independent test house.
17. **Technical File Ref KAV15 – 45** – The Technical File for the KAV15-45 model range is lodged at Element Materials Technology Ltd.

SPARE PARTS – KAV 18 W/D

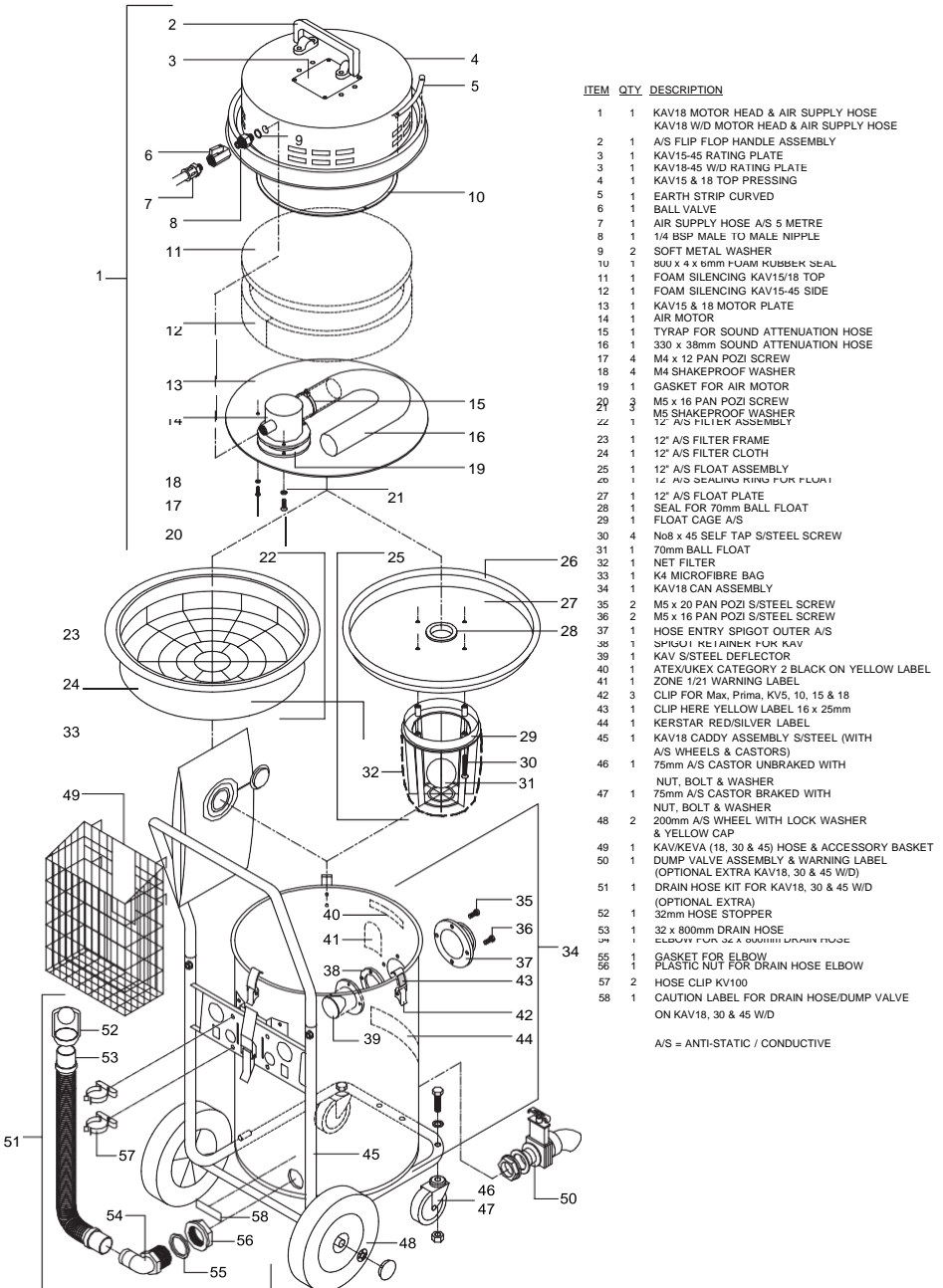

ITEM	QTY	DESCRIPTION
1	1	KAV18 MOTOR HEAD & AIR SUPPLY HOSE KAV18 W/D MOTOR HEAD & AIR SUPPLY HOSE
2	1	A/S FLIP FLOP HANDLE ASSEMBLY
3	1	KAV15-45 RATING PLATE
3	1	KAV18-45 W/D RATING PLATE
4	1	KAV15 & 18 TOP PRESSING
5	1	EARTH STRIP CURVED
6	1	BALL VALVE
7	1	AIR SUPPLY HOSE A/S 5 METRE
8	1	1/4 BSP MALE TO MALE NIPPLE
9	2	SOFT METAL WASHER
10	1	800 x 4 x 6mm F-OAM RUBBER SEAL
11	1	FOAM SILENCING KAV15/18 TOP
12	1	FOAM SILENCING KAV15-45 SIDE
13	1	KAV15 & 18 MOTOR PLATE
14	1	AIR MOTOR
15	1	TYRAP FOR SOUND ATTENUATION HOSE
16	1	330 x 38mm SOUND ATTENUATION HOSE
17	4	M4 x 12 PAN POZI SCREW
18	4	M4 SHAKEPROOF WASHER
19	1	GASKET FOR AIR MOTOR
20	3	M5 x 16 PAN POZI SCREW
21	3	M5 SHAKEPROOF WASHER
22	1	12" A/S FILTER ASSEMBLY
23	1	12" A/S FILTER FRAME
24	1	12" A/S FILTER CLOTH
25	1	12" A/S FLOAT ASSEMBLY
26	1	14" A/S SEALING RING FOR FLOOR
27	1	12" A/S FLOAT PLATE
28	1	SEAL FOR 70mm BALL FLOAT
29	1	FLOAT CAGE A/S
30	4	No8 x 45 SELF TAP S/STEEL SCREW
31	1	70mm BALL FLOAT
32	1	NET FILTER
33	1	K4 MICROFIBRE BAG
34	1	KAV18 CAN ASSEMBLY
35	2	M5 x 20 PAN POZI S/STEEL SCREW
36	2	M5 x 16 PAN POZI S/STEEL SCREW
37	1	HOSE ENTRY SPIGOT OUTER A/S
38	1	SPIGOT KAV18/KAV15
39	1	KAV S/STEEL DEFLECTOR
40	1	ATEX/UKEX CATEGORY 2 BLACK ON YELLOW LABEL
41	1	ZONE 1/21 WARNING LABEL
42	3	CLIP FOR Max. Prima, KV5, 10, 15 & 18
43	1	CLIP HERE YELLOW LABEL 16 x 25mm
44	1	KERSTAR RED/SILVER LABEL
45	1	KAV18 CADDY ASSEMBLY S/STEEL (WITH A/S WHEELS & CASTORS)
46	1	75mm A/S CASTOR UNBRAKED WITH NUT, BOLT & WASHER
47	1	75mm A/S CASTOR BRAKED WITH NUT, BOLT & WASHER
48	2	200mm A/S WHEEL WITH LOCK WASHER & YELLOW CAP
49	1	KAV/KEVA (18, 30 & 45) HOSE & ACCESSORY BASKET
50	1	DUMP VALVE ASSEMBLY & WARNING LABEL (OPTIONAL EXTRA KAV18, 30 & 45 W/D)
51	1	DRAIN HOSE KIT FOR KAV18, 30 & 45 W/D (OPTIONAL EXTRA)
52	1	32mm HOSE STOPPER
53	1	32 x 800mm DRAIN HOSE
54	1	ELBOW FOR 32 x 800mm DRAIN HOSE
55	1	GASKET FOR ELBOW
56	1	PLASTIC NUT FOR DRAIN HOSE ELBOW
57	2	HOSE CLIP KV100
58	1	CAUTION LABEL FOR DRAIN HOSE/DUMP VALVE ON KAV18, 30 & 45 W/D

A/S = ANTI-STATIC / CONDUCTIVE

Note
This drawing/parts list also covers the Dry Pick-Up only version of this model

SPARE PARTS – KAV 20 W/D

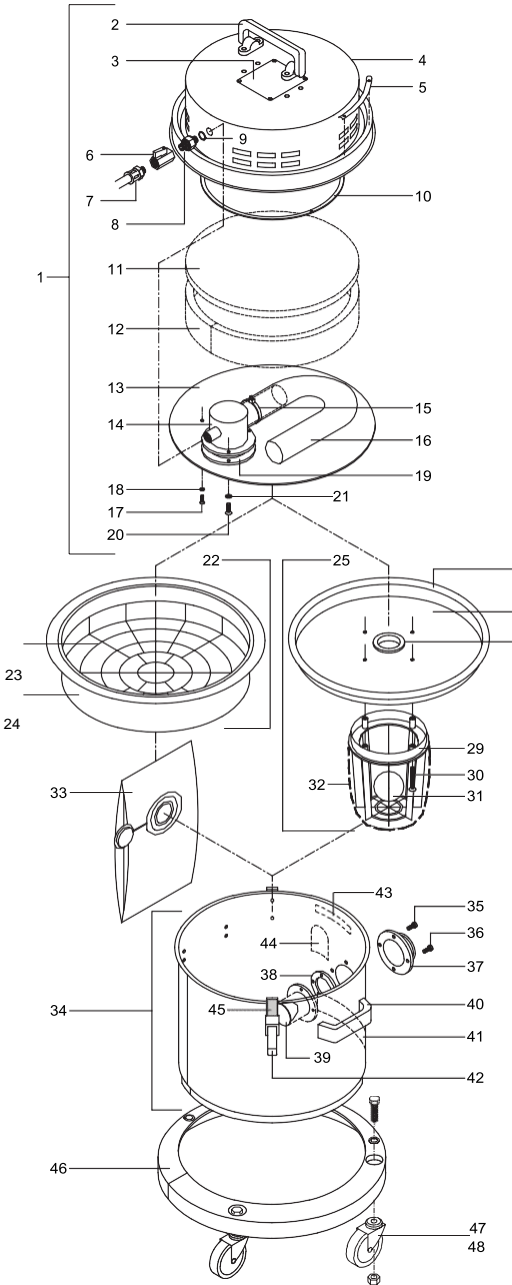

ITEM	QTY	DESCRIPTION
1	1	KAV20 MOTOR HEAD & AIR SUPPLY HOSE
2	1	KAV20 W/D MOTOR HEAD & AIR SUPPLY HOSE
3	1	A/S FLIP FLOP HANDLE ASSEMBLY
4	1	KAV15-45 RATING PLATE
5	1	KAV18-45 W/D RATING PLATE
6	1	KAV20-45 TOP PRESSING
7	1	EARTH STRIP CURVED
8	1	BALL VALVE
9	1	AIR SUPPLY HOSE A/S 5 METRE
10	1	1/4 BSP MALE TO MALE NIPPLE
11	2	SOFT METAL WASHER
12	1	850 x 4 x 6mm FOAM RUBBER SEAL
13	1	FOAM SILENCING KAV20-45 TOP
14	1	FOAM SILENCING KAV15-45 SIDE
15	1	KAV20-45 MOTOR PLATE
16	1	AIR MOTOR
17	1	TYRAP FOR SOUND ATTENUATION HOSE
18	1	500 x 38mm SOUND ATTENUATION HOSE
19	1	M4 x 12 PAN POZI SCREW
20	1	M4 SHAKEPROOF WASHER
21	1	GASKET FOR AIR MOTOR
22	3	M5 x 16 PAN POZI SCREW
23	1	M5 SHAKEPROOF WASHER
24	1	14" A/S FILTER ASSEMBLY
25	1	14" A/S FILTER FRAME
26	1	14" A/S FILTER CLOTH

25	1	14" A/S FLOAT ASSEMBLY
26	1	14" A/S SEALING RING FOR FLOAT
27	1	14" A/S FLOAT PLATE
28	1	SEAL FOR 70mm BALL FLOAT
29	1	FLOAT CAGE A/S
30	4	N08 x 45 SELF TAP S/STEEL SCREW
31	1	70mm BALL FLOAT
32	1	NET FILTER
33	1	K4 MICROFIBRE BAG
34	1	KAV20 CAN ASSEMBLY
35	2	M5 x 20 PAN POZI S/STEEL SCREW
36	2	M5 x 16 PAN POZI S/STEEL SCREW
37	1	HOSE ENTRY SPIGOT OUTER A/S
38	1	SPIGOT RETAINER FOR KAV
39	1	KAV S/STEEL DEFLECTOR
40	2	A/S CURVED SURFACE HANDLE WITH SCREWS & WASHERS
41	1	KERSTAR RED/SILVER LABEL
42	2	KV20-110 CLIP FOR METAL HEAD
43	1	ATEX/LUKEX CATEGORY 2 BLACK ON YELLOW LABEL
44	1	ZONE 1/21 WARNING LABEL
45	1	CLIP HERE YELLOW LABEL 23 x 34mm
46	1	KAV/KEVA 20 A/S CHASSIS (NO CASTORS)
47	3	75mm A/S CASTOR UNBRAKED WITH NUT, BOLT & WASHER
48	1	75mm A/S CASTOR BRAKED WITH NUT, BOLT & WASHER

A/S = ANTI-STATIC / CONDUCTIVE

Note This drawing/parts list also covers the Dry Pick-Up only version of this model

SPARE PARTS – KAV 30 & 45 W/D

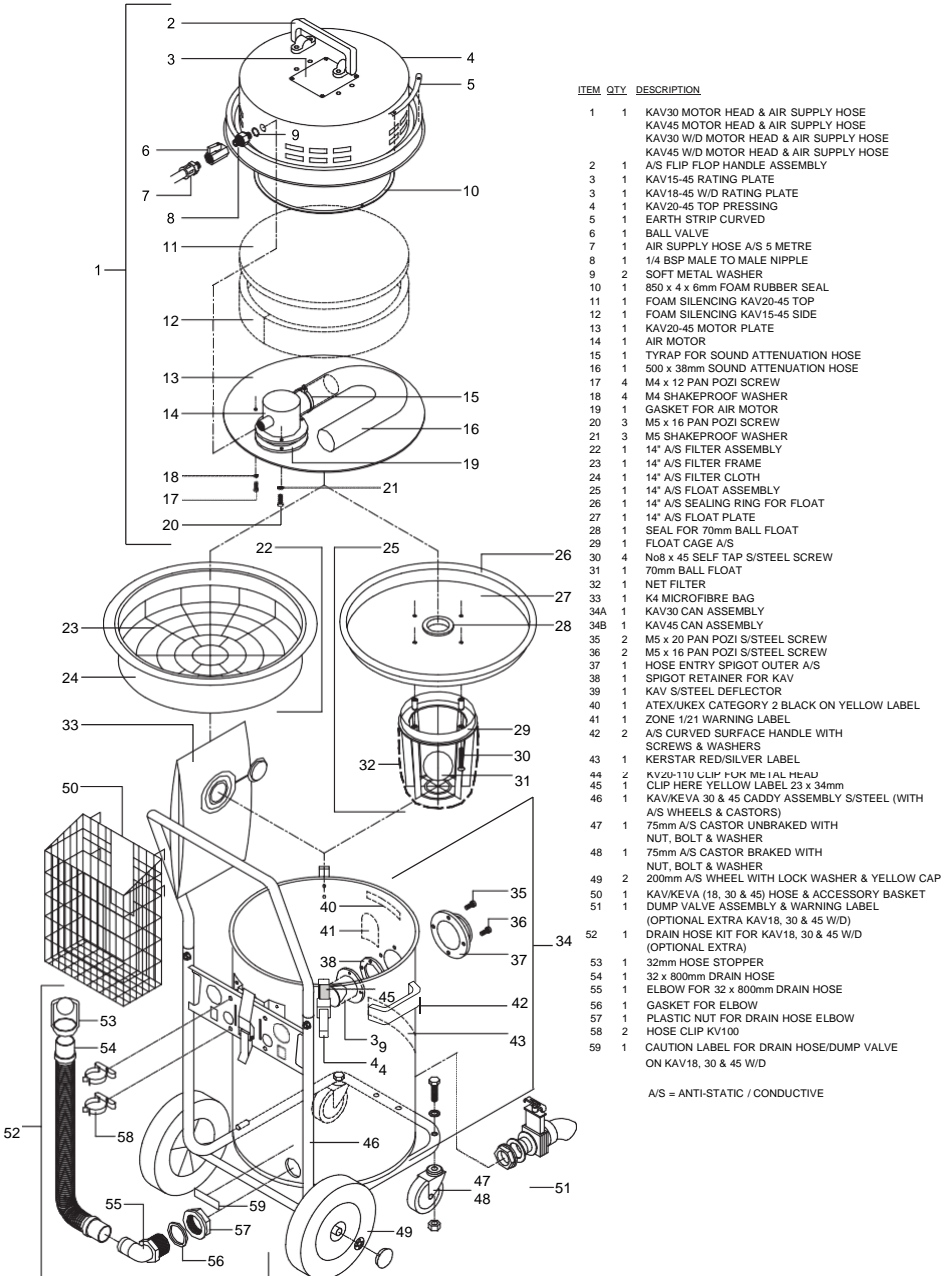



ITEM	QTY	DESCRIPTION
1	1	KAV30 MOTOR HEAD & AIR SUPPLY HOSE KAV45 MOTOR HEAD & AIR SUPPLY HOSE KAV30 W/D MOTOR HEAD & AIR SUPPLY HOSE KAV45 W/D MOTOR HEAD & AIR SUPPLY HOSE
2	1	A/S FLIP FLOP HANDLE ASSEMBLY
3	1	KAV15-45 RATING PLATE
3	1	KAV18-45 W/D RATING PLATE
4	1	KAV20-45 TOP PRESSING
5	1	EARTH STRIP CURVED
6	1	BALL VALVE
7	1	AIR SUPPLY HOSE A/S 5 METRE
8	1	1/4 BSP MALE TO MALE NIPPLE
9	2	SOFT METAL WASHER
10	1	850 x 4 x 6mm FOAM RUBBER SEAL
11	1	FOAM SILENCING KAV20-45 TOP
12	1	FOAM SILENCING KAV15-45 SIDE
13	1	KAV20-45 MOTOR PLATE
14	1	AIR MOTOR
15	1	TYRAP FOR SOUND ATTENUATION HOSE
16	1	500 x 38mm SOUND ATTENUATION HOSE
17	4	M4 x 12 PAN POZI SCREW
18	4	M4 SHAKEPROOF WASHER
19	1	GASKET FOR AIR MOTOR
20	3	M5 x 16 PAN POZI SCREW
21	3	M5 SHAKEPROOF WASHER
22	1	14" A/S FILTER ASSEMBLY
23	1	14" A/S FILTER FRAME
24	1	14" A/S FILTER CLOTH
25	1	14" A/S FLOAT ASSEMBLY
26	1	14" A/S SEALING RING FOR FLOAT
27	1	14" A/S FLOAT PLATE
28	1	SEAL FOR 70mm BALL FLOAT
29	1	FLOAT CAGE A/S
30	4	N8 x 45 SELF TAP S/STEEL SCREW
31	1	70mm BALL FLOAT
32	1	NET FILTER
33	1	K4 MICROFIBRE BAG
34A	1	KAV30 CAN ASSEMBLY
34B	1	KAV45 CAN ASSEMBLY
35	2	M5 x 20 PAN POZI S/STEEL SCREW
36	2	M5 x 16 PAN POZI S/STEEL SCREW
37	1	HOSE ENTRY SPIGOT OUTER A/S
38	1	SPIGOT RETAINER FOR KAV
39	1	KAV S/STEEL DEFLECTOR
40	1	ATEX/UKEX CATEGORY 2 BLACK ON YELLOW LABEL
41	1	ZONE 1/21 WARNING LABEL
42	2	A/S CURVED SURFACE HANDLE WITH SCREWS & WASHERS
43	1	KERSTAR RED/SILVER LABEL
44	2	KV20-110 ULLIP FOR METAL HEAD
45	1	CLIP HERE YELLOW LABEL 23 x 34mm
46	1	KAV/KEVA 30 & 45 CADDY ASSEMBLY S/STEEL (WITH A/S WHEELS & CASTORS)
47	1	75mm A/S CASTOR UNBRAKED WITH NUT, BOLT & WASHER
48	1	75mm A/S CASTOR BRAKED WITH NUT, BOLT & WASHER
49	2	200mm A/S WHEEL WITH LOCK WASHER & YELLOW CAP
50	1	KAV/KEVA (18, 30 & 45) HOSE & ACCESSORY BASKET
51	1	DUMP VALVE ASSEMBLY & WARNING LABEL (OPTIONAL EXTRA KAV18, 30 & 45 W/D)
52	1	DRAIN HOSE KIT FOR KAV18, 30 & 45 W/D (OPTIONAL EXTRA)
53	1	32mm HOSE STOPPER
54	1	32 x 800mm DRAIN HOSE
55	1	ELBOW FOR 32 x 800mm DRAIN HOSE
56	1	GASKET FOR ELBOW
57	1	PLASTIC NUT FOR DRAIN HOSE ELBOW
58	2	HOSE CLIP KV100
59	1	CAUTION LABEL FOR DRAIN HOSE/DUMP VALVE ON KAV18, 30 & 45 W/D

A/S = ANTI-STATIC / CONDUCTIVE

Note
This drawing/parts list also covers the Dry Pick-Up only version of this model

EU DECLARATION OF CONFORMITY (DoC)

KERSTAR

Manufacturer's name:	Filtermist Limited	Machinery covered by this declaration:	
Full address:	Telford 54 Business Park, Nedge Hill, Telford, Shropshire TF3 3AL	Description:	Compressed air powered canister type portable vacuum cleaner & interceptor tank
	+44 (0)1952 290500	Function:	Vacuum to collect dry, wet & dry and type H dust/debris
		Type:	KAV Air powered vacuum (KAV 15-45) and KAVIT interceptortanks (KAVIT20-45)
Authorised Representative:	Absolent AB	Model:	KAV 15, KAV 18, KAV 20, KAV 30, KAV 45, KAV 18 W/D, KAV 20 W/D, KAV 30 W/D, KAV 45 W/D, KAV 15 H, KAV 18 H, KAV 20 H, KAV30 H, KAV 45 H, KAVIT 20, KAVIT 30, KAVIT 45, KAVIT 20 H, KAVIT 30 H, KAVIT 45 H
Full address:	Staplaregatan 1 SE-531 40 Lidköping Sweden	Serial No.:	See unit
Filtermist UK declare under our sole responsibility as the manufacturer that the above object(s)/products are in conformity with the ATEX directive 2014/34/EU covering Equipment and protective systems intended for use in potentially explosive atmospheres.			
The machinery also conforms to the following Directives:	RoHS Directive 2011/65/EU		
The following standards have been used:	EN ISO 80079-36:2016, EN ISO 80079-37:2016; EN ISO 4414:2010		
ATEX Coding:  II 2 D Ex h IIC T50°C Db  II 2 G Ex h IIC T6 Gb	The Kerstar Air Vacuums 'KAV15-45' range are a series of standard can style compressed air powered industrial vacuum cleaners. Compressed air is used to create a vacuum by venturi effect in dry, wet, or Hazardous Type H environments. KAV 15 & 20 models are mounted on a chassis with four castors, while 18, 30, 45 are mounted on a steel caddy with two fixed wheels and castors. The vacuum cleaners, and optional accompanying interceptor tanks are constructed from conductive materials to ensure compliance with ATEX directive.		
Notified Body (Where applicable): Element Materials Technology Ltd. Technical File Holder DIF 2812-006 Certificate number EMT17ATEX0050X		4 digit notified body number: 2812	
Person authorised to compile the technical file (based in the European Community):	Name:	Absolent AB	
	Address:	Staplaregatan 1 SE-531 40 Lidköping, Sweden	
Specific Conditions of use. The equipment is supplied with a conductive air supply hose. It is the end user's responsibility to ensure a good earth connection is maintained at the compressed air connection point whilst the equipment is in use. The relevant authorised person undertakes to transmit, in response to a reasoned request by the national authorities, relevant information on the machinery. This information will be transmitted by: (email, post)			
Person authorised to make this declaration:	Name:	Craig Haynes	
	Position in company:	Product Engineering Team Lead	
	Signature:		
	Place of Declaration:	Filtermist Limited, Telford 54 Business Park, Nedge Hill, Telford, Shropshire, TF3 3AL	
	Date of Declaration:	1 Jan 2024	

**UKCA DECLARATION OF CONFORMITY
(DoC)**

KERSTAR

Manufacturer's name:		Filtermist Limited		Machinery covered by this declaration:	
Full address:		Telford 54 Business Park, Nedge Hill, Telford, Shropshire TF3 3AL		Description:	
Tel:		+44 (0)1952 290500		Function:	
				Type:	
				Model:	
				Serial No.:	
<p align="center">Filtermist UK declare under our sole responsibility as the manufacturer that the above object(s)/products are in conformity with the "Equipment and Protective Systems Intended for use in Potentially Explosive Atmospheres Regulations 2016"</p>					
The machinery also conforms to the following regulations:		Restriction of the Use of Certain Hazardous Substances in Electrical and Electronic Equipment Regulations 2012			
The following standards have been used:		BS EN ISO 80079-36:2016, BS EN ISO 80079-37:2016; BS EN ISO 4414:2010			
ATEX/UKEX Coding:		The Kerstar Air Vacuums 'KAV15-45' range are a series of standard can style compressed air powered industrial vacuum cleaners. Compressed air is used to create a vacuum by venturi effect in dry, wet, or Hazardous Type H environments. KAV 15 & 20 models are mounted on a chassis with four castors, while 18, 30, 45 are mounted on a steel caddy with two fixed wheels and castors. The vacuum cleaners, and optional accompanying interceptor tanks are constructed from conductive materials to ensure compliance with ATEX directive, and the UK equivalent.			
II 2 D Ex h IIIC T50°C Db					
II 2 G Ex h IIC T6 Gb					
Notified Body (Where applicable):		4 digit notified body number:			
Element Materials Technology Ltd. Technical File Holder DIF 0891-011 Certificate number EMT21UKEX0068		0891			
<p>Specific Conditions of use. The equipment is supplied with a conductive air supply hose. It is the end user's responsibility to ensure a good earth connection is maintained at the compressed air connection point whilst the equipment is in use. The relevant authorised person undertakes to transmit, in response to a reasoned request by the national authorities, relevant information on the machinery. This information will be transmitted by: (email, post)</p>					
Person authorised to make this declaration:		Name:			
		Craig Haynes			
		Position in company:			
		Product Engineering Team Lead			
		Signature:			
					
		Place of Declaration:			
		Filtermist Limited, Telford 54 Business Park, Nedge Hill, Telford, Shropshire, TF3 3AL			
		Date of Declaration:			
		1 Jan 2024			

TOOL KIT KAV 18, 20, 30 & 45 W/D

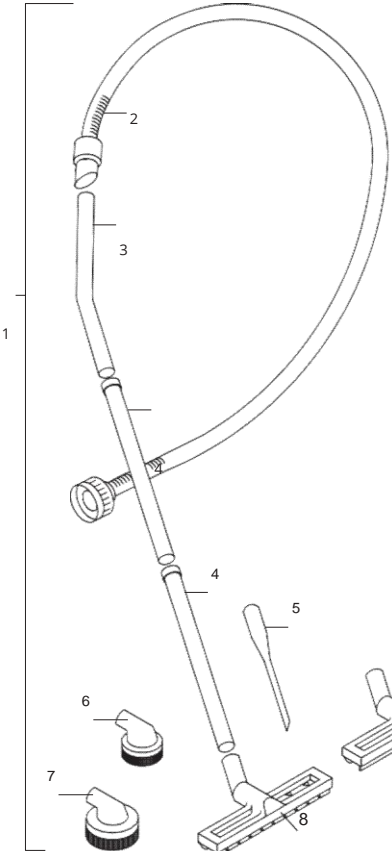

Item	QTY	Part No.	Description
1	1	25-132-30-052	38mm WD1 A/S Tool Kit (Items 2-9)
2	1	25-204-20-079	38mm x 3m A/S Hose Assembly
3	1	25-204-10-1878	38mm Stainless Steel Bent Hose End
4	2	25-204-10-1877	38mm Stainless Steel Wand
5	1	25-204-10-212	38mm Crevice Tool A/S Plastic
6	1	25-204-10-1296	38 x 70mm A/S Dusting Brush
7	1	25-204-20-195	38 x 100mm A/S Dusting Brush
8	1	25-204-20-1330	38 x 375mm A/S Heavy Duty FloorTool with Brushes
9	1	25-204-20-1331	38 x 375mm A/S Heavy Duty FloorTool with Blades

A/S = Anti-Static/Conductive



Part of Absolent
Air Care Group

Supplied by:

Filtermist Limited
Telford 54 Business Park
Nedge Hill
Telford
Shropshire
TF3 3AL
England

Version: January 2024

www.kerstar.com

Kerstar products are manufactured by
Filtermist Limited

Tel: +44 (0)1952 290500

Email: sales@filtermist.com

www.filtermist.co.uk

Although every effort has been made to maintain accuracy of information and specifications in this manual, no liability can be accepted for errors and omissions and this manual forms no part of a contract. Filtermist Limited may introduce modifications and improvements from time to time, and consequently the details given in this manual are subject to alteration without notice. Please visit www.kerstar.com to download the latest version of this manual.